

2688 Brown Circle ■ Smyrna, Georgia 30080  
 404-493-3695 cell ■ 770-432-7149 fax  
 elements@mindphg.com

THESE PLANS ARE THE PROPERTY OF ELEMENTS OF LAND DESIGN, LLC AND WILL BE RETURNED TO US IMMEDIATELY UPON COMPLETION. NO PART OF THESE PLANS MAY BE REPRODUCED OR TRANSMITTED IN ANY FORM OR BY ANY MEANS, WITHOUT THE WRITTEN CONSENT OF ELEMENTS OF LAND DESIGN, LLC. ALL COMMON LAW RIGHTS OF COPYRIGHT ARE HEREBY SPECIFICALLY RESERVED.

**FRIENDSHIP FOREST**  
 City of Clarkston  
 4380 East Ponce de Leon Avenue  
 Clarkston, Georgia  
 30021

**REVISIONS**

November 4, 2011 Per meeting with City

DATE: October 19, 2011  
 ELEMENTS DRAWING NO.: .dwg

**East Side Planting Plan**  
 Ga. Soil & Water Commission  
 Grant

Sheet 3 / 4

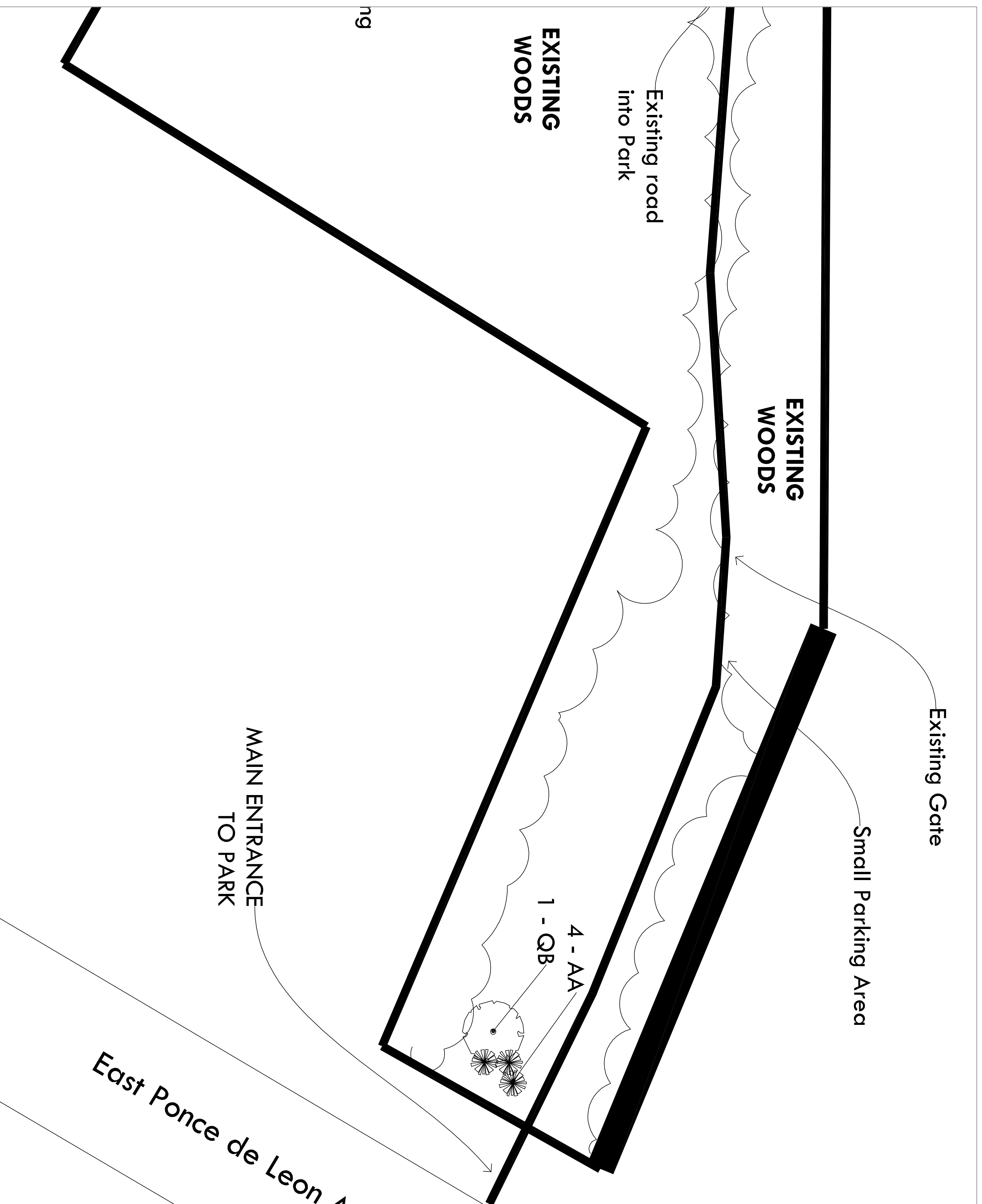

Friendship Forest Plant List

Key	QTY	Botanical Name/Common Name	Min. Cal.	Min. Ht.	Code	Spacing	Soil/Planting/Management	Comments	Site Notes
AA	6	Washingtonia robusta "Palm Spine" / Washingtonia robusta	NA	5'-6"	Can.	15' x 6'	Multi-trunk		
AI	3	Asimina triloba / Pawpaw	2'-2"	5' Ht.	8 & 8	15' x 6'	Single stem	Frish have sweet brown like flavor.	Y
BI	2	Juniperus sp. "Dwarf Blue" / Juniperus sp.	NA	8' Ht.	7' gnd.	35' x 6'	Multi stem	Establishing bank	Y
CC	6	Cornus canadensis / Spicebush	1.5"	6'	7' gnd.	15' x 6'	Single stem	Understory, shade tolerant tree w/ heavy bark	Y
CI	11	Hamamelis virginiana "Winged" / Hamamelis virginiana	2"	6'	Can.	20' x 6'	Single, upright stem		Y
CV	6	Cornus sp. "White Swallow" / Cornus sp.	1.5"	7'-8'	Can.	20' x 6'	Single, upright stem	8 & 8 to be completed in 2012	
DV	5	Dryopteris sp. "Venus" / Dryopteris sp.	NA	4'	7' gnd.	30' x 6'	Multi-trunk	Shade tolerant w/ heavy bark	Y
HA	10	Hesperis matronalis "White" / Hesperis matronalis	1.5"	10'	7' gnd.	25' x 6'	Single stem	Shade tolerant w/ heavy bark	Y
FA	3	Ficus sp. "Moss" / Ficus sp.	1.5"	10'	7' gnd.	30' x 6'	Single stem	Shade tolerant w/ heavy bark	Y
QB	8	Quercus sp. "White" / Quercus sp.	2"	10'	7' gnd.	40' x 6'	Single stem	Frish on main ridge in soil in winter	Y
UA	4	Ulmus sp. "Weeping" / Ulmus sp.	2"	10'	7' gnd.	35' x 6'	Single stem	Good soil binding structure w/ yellow fall foliage	Y
Total Trees 65									

